

502-924 Esquimalt Rd, Victoria, BC

Main Floor Total Exterior Area 769 sq ft
Total Interior Area 723 sq ft

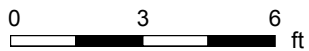

PREPARED: Jun, 2019

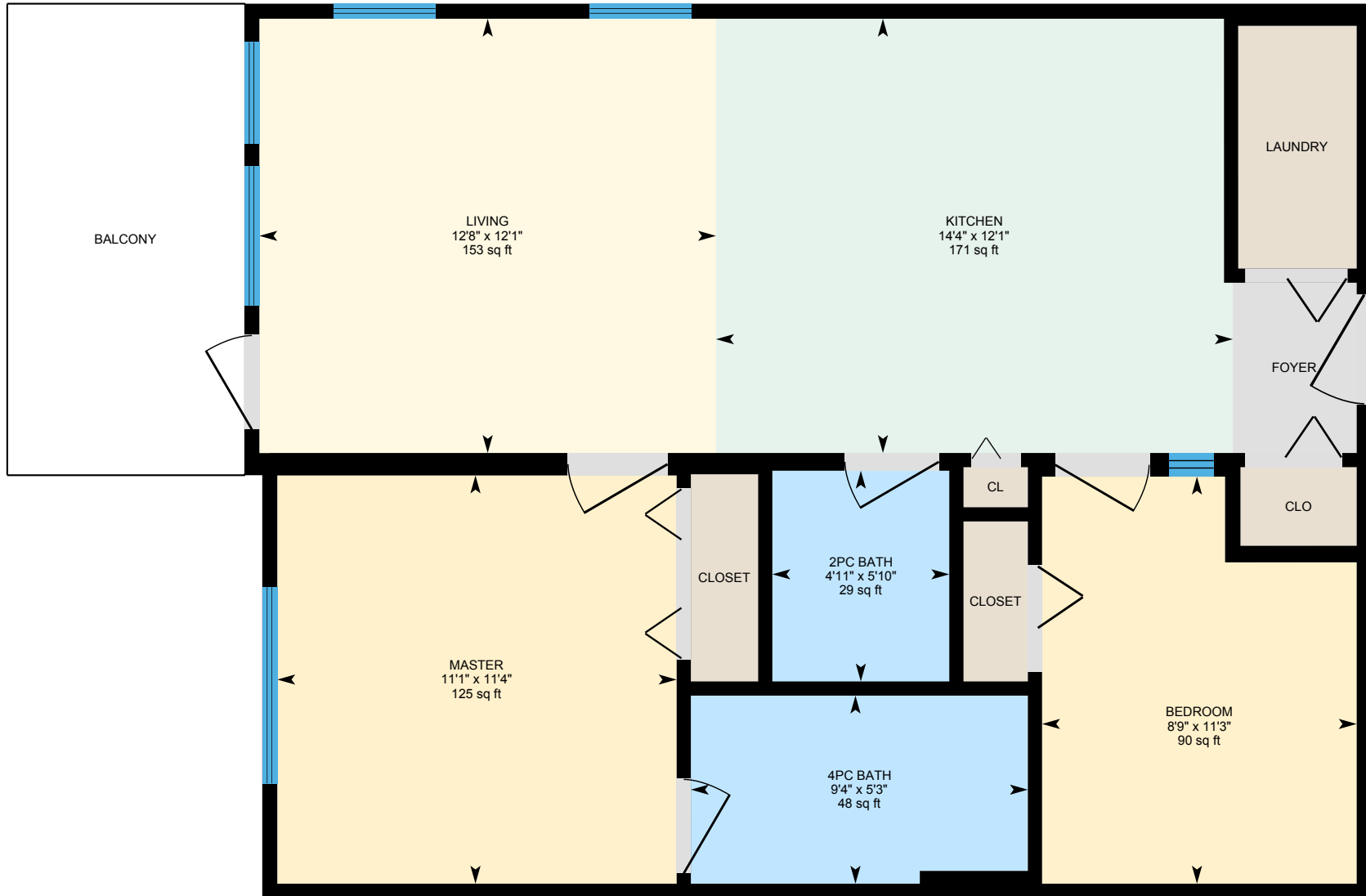

White regions are excluded from total floor area. All room dimensions and floor areas must be considered approximate and are subject to independent verification. For method of measurement please see <https://youriguide.com/measure/>.

502-924 Esquimalt Rd, Victoria, BC

Property Details

Room Measurements

Only major rooms are listed. Some listed rooms may be excluded from total interior floor area (e.g. garage). Room dimensions are largest length and width; parts of room may be smaller. Room area is not always equal to product of length and width.

Main Building

MAIN FLOOR

2pc Bath: 5'10" x 4'11" | 29 sq ft
4pc Bath: 5'3" x 9'4" | 48 sq ft
Bedroom: 11'3" x 8'9" | 90 sq ft
Kitchen: 12'1" x 14'4" | 171 sq ft
Living: 12'1" x 12'8" | 153 sq ft
Master: 11'4" x 11'1" | 125 sq ft

Floor Area Information

For explanation of floor area calculations and method of measurement please see <https://youriguide.com/measure/>.

Main Building

MAIN FLOOR

Interior Area: 723 sq ft
Perimeter Wall Length: 111 ft
Perimeter Wall Thickness: 5.0 in
Exterior Area: 769 sq ft

Total Above Grade Floor Area

Main Building Interior: 723 sq ft
Main Building Exterior: 769 sq ft

Customer Name: The Neal Estate Team
Customer Company: RE/MAX Alliance
Prepared: Jun 8, 2019

This Property was measured by CMC Photography & Floor Plan Services.